

1. Before installing, first check to ensure you have received all the package contents.

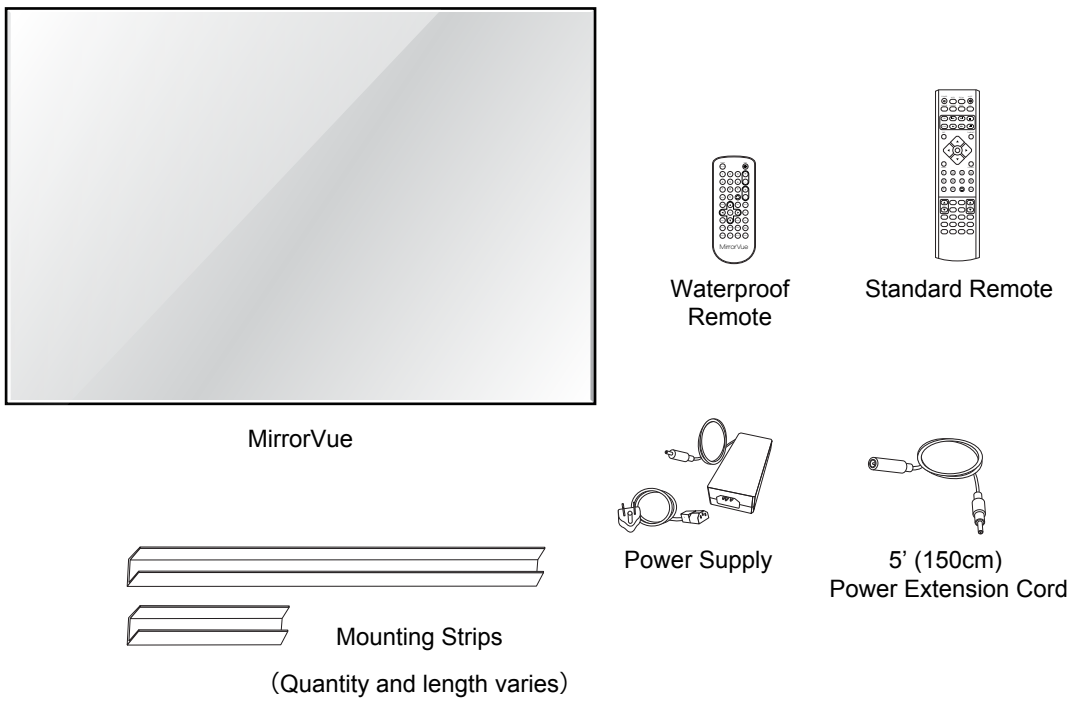

2. Verify the wall is prepared correctly for installation. Determine the type of screws and bolts needed for your wall. Drill holes into the mounting strips. Positioning of the holes is determined on-site and depends on your wall. Install mounting strips, being vigilant to ensure strips are securely fastened.

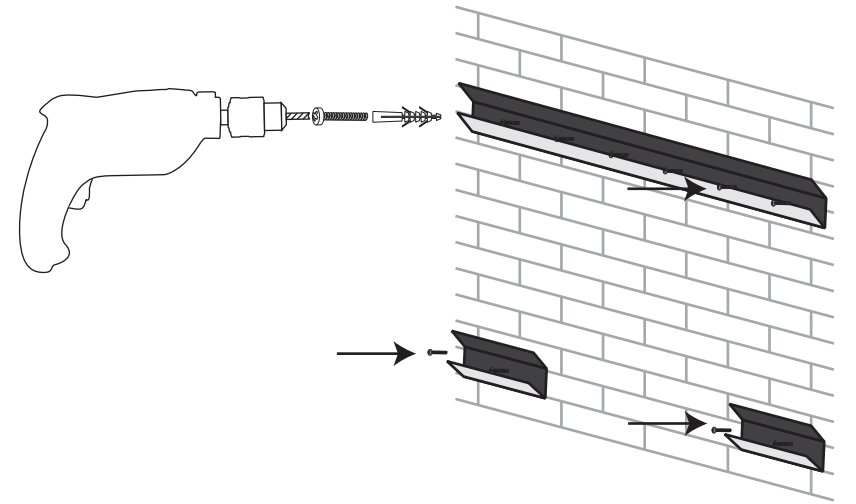

3. Prior to installation, we recommend testing your Mirror TV. When doing so, use a protective, soft surface to avoid damaging or scratching the mirror glass. Remove the water protective cover from the cable box and make desired connections to your TV and attach power supply. Re-attach the protective cover to cable box.

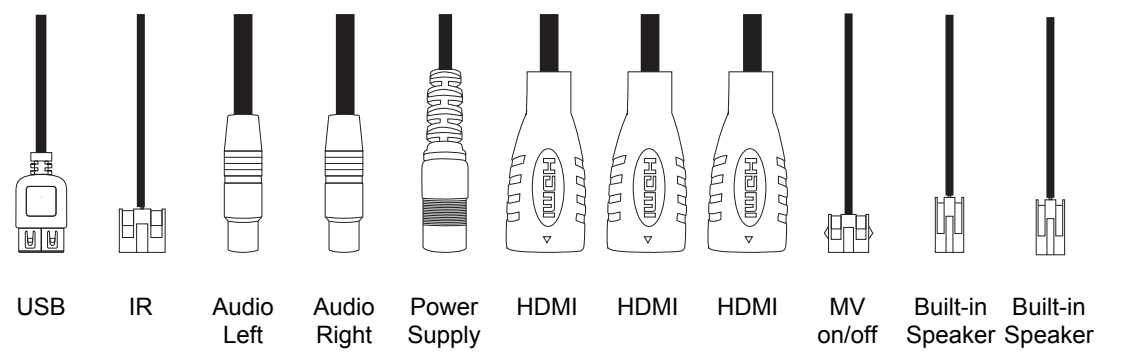
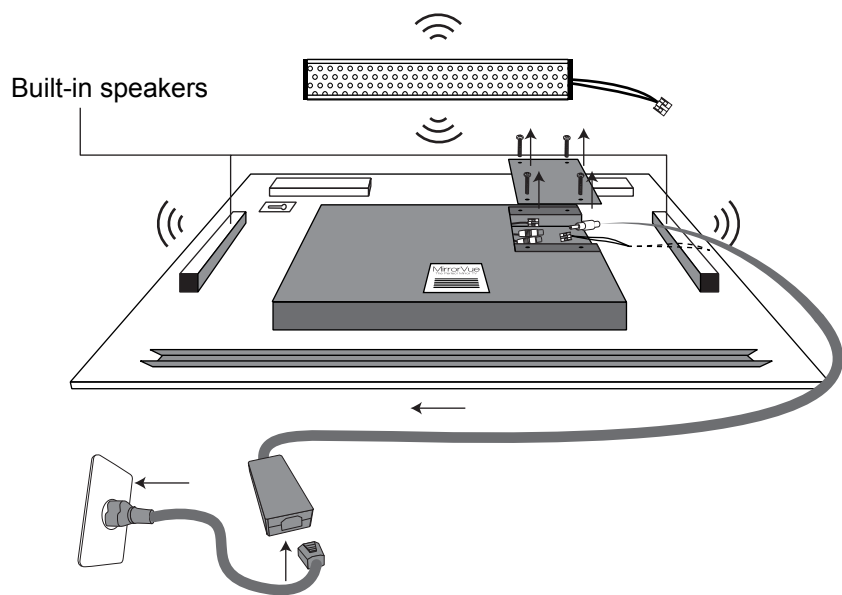

6. OPTIONAL: Connect your set-top box (STB); (REQUIRES purchase of optional Infrared Extension (IR) Cable). Attach STB via the HDMI port. Then connect the IR Extension cable to the TV and attach the sticky part to the IR Sensor of your STB. Consult your STB manual or vendor to determine location or IR Sensor. Then, connect STB to power and Source input (RF, LAN/Wi-Fi).

The IR connection between TV and STB makes it possible to control the STB even when hidden out of sight. To avoid using two remote controls, consider the AQUA waterproof remote control or OCTO-500 smart remote from Evervue accessories. Visit www.evervue.com for more information.

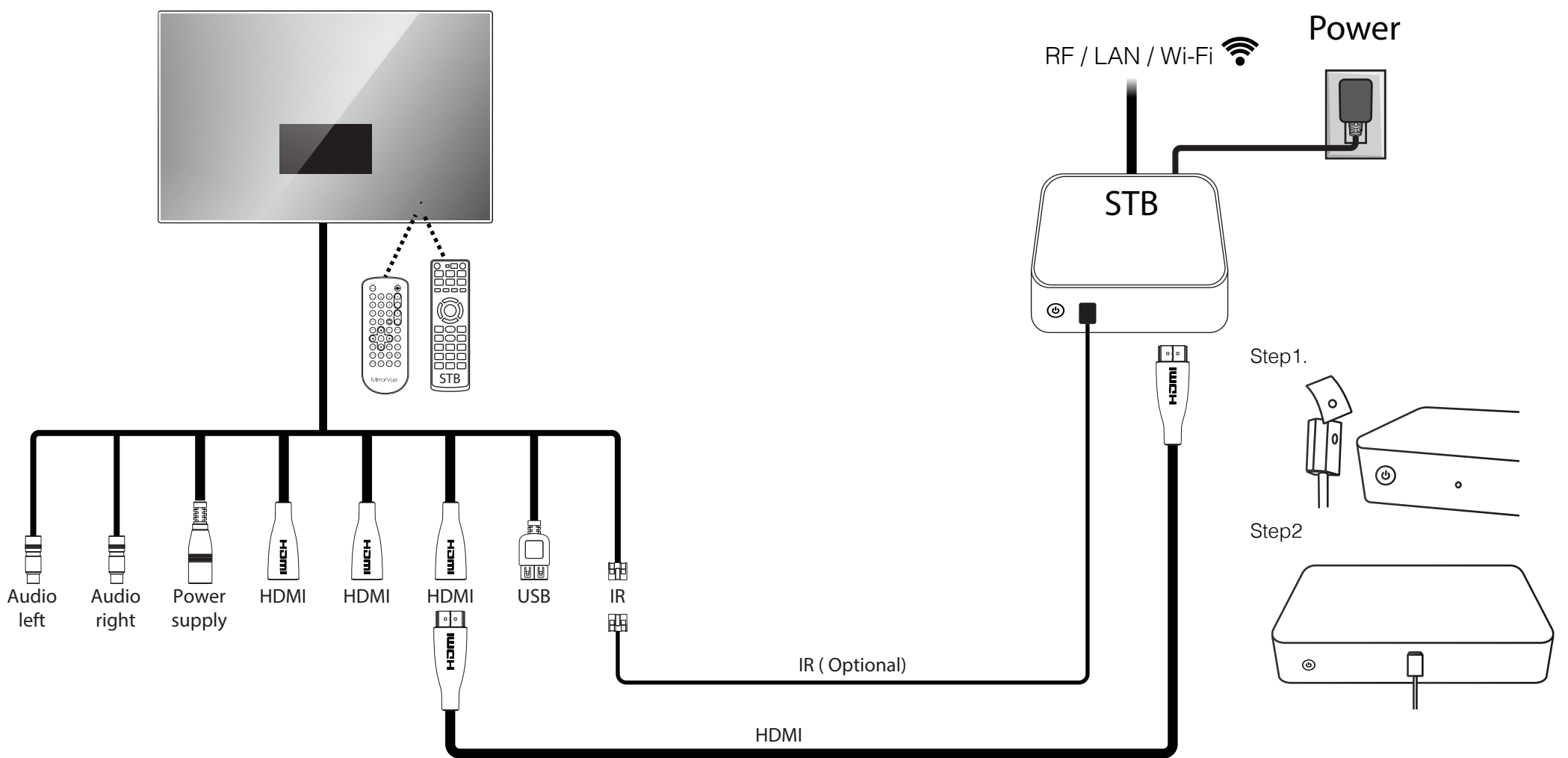

5. Hang the Mirror TV in the fastened mounting strips. Ensure mounting strips interlock securely and are tight fitting. (Note: Recommended number of persons to assist with installation: 3+.)

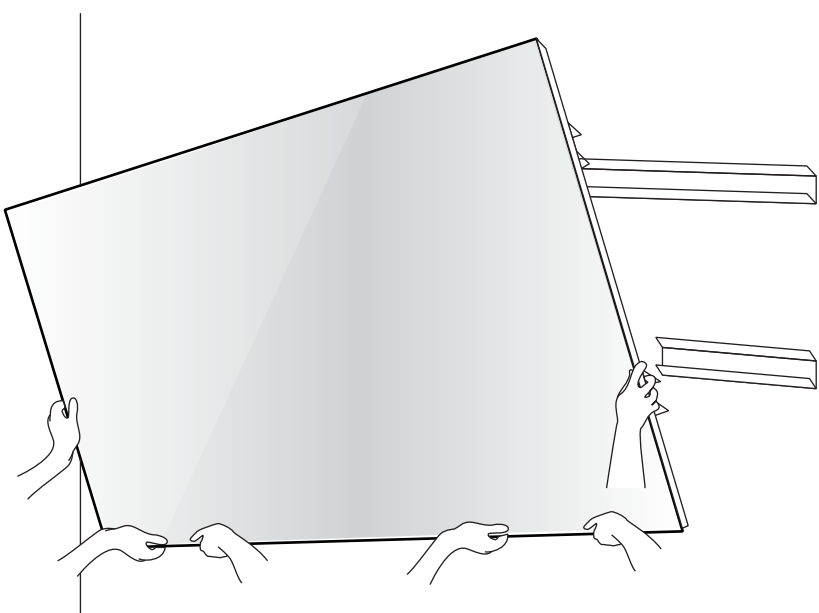

6. Installation is complete. Follow the instructions in the TV menu to personalize your settings as needed. Enjoy your new MirrorVue!



* Note: It is the installer's responsibility that all electrical, audio, visual, and framing construction is code compliant.
 ** Note: Inputs and Outputs vary depending on region.